



Milburn House

Stanmore

£350,000

Davidson Frost-Wellings are pleased to offer this large modern one bedroom flat in the center of Stanmore. This property comprises of an open plan living space with a fitted kitchen, private roof terrace and has lots of natural light.

Stanmore is a delightful village, located in the North West of London. It offers the perfect blend of suburban tranquillity and urban convenience, making it a highly desirable area for property buyers. Known for its leafy streets, open green spaces and a sense of community, Stanmore is an ideal location for those seeking a peaceful lifestyle without sacrificing connectivity to central London.

Lease 996 years remaining
Ground rent Peppercorn
Service charge £1930 pa
Harrow Council Tax Band C

- One bedroom
- Bathroom
- Modern fitted kitchen
- Private roof terrace
- Long lease
- Central location

Viewing

Please contact our Davidson Frost-Wellings Office on 020 8954 8806 if you wish to arrange a viewing appointment for this property or require further information.

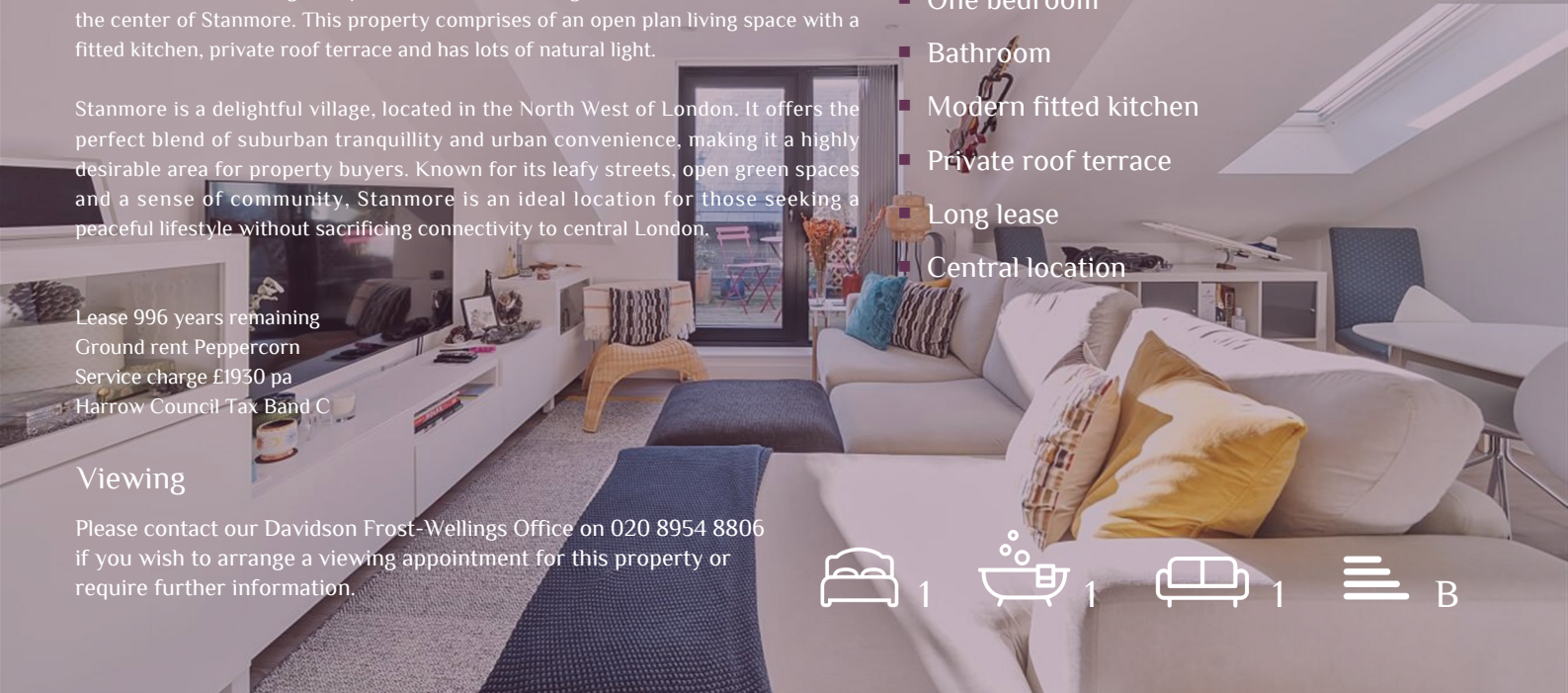

Floor Plan

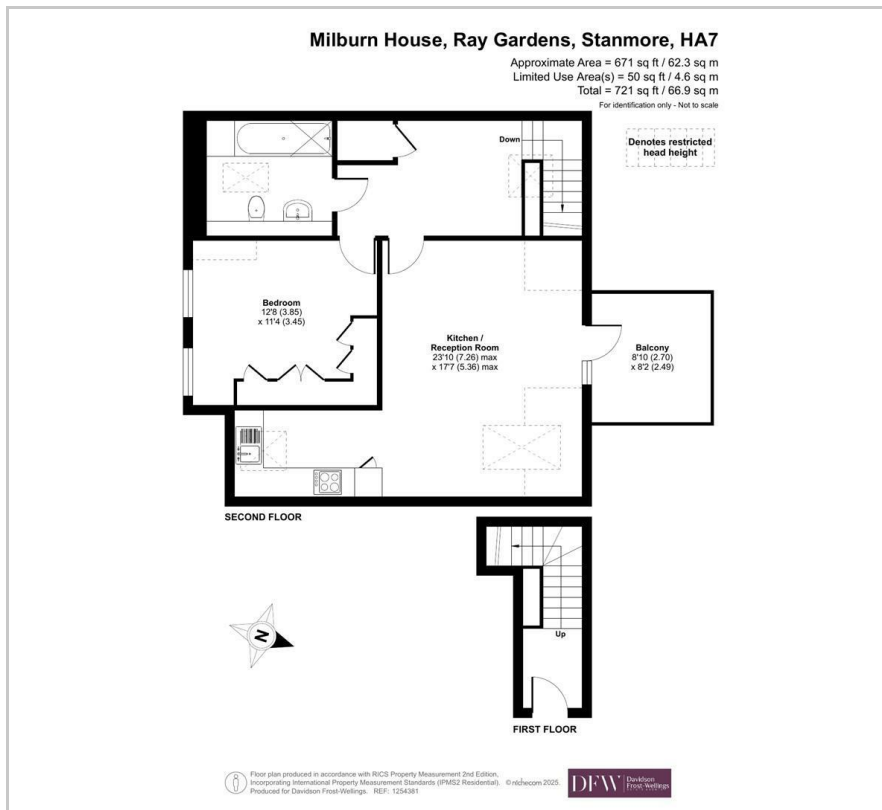

Area Map



Energy Efficiency Rating

	Current	Potential
Very energy efficient - lower running costs		
(92 plus) A		
(81-91) B	83	83
(69-80) C		
(55-68) D		
(39-54) E		
(21-38) F		
(1-20) G		
Not energy efficient - higher running costs		
England & Wales	EU Directive 2002/91/EC	



These particulars, whilst believed to be accurate are set out as a general outline only for guidance and do not constitute any part of an offer or contract. Intending purchasers should not rely on them as statements of representation of fact, but must satisfy themselves by inspection or otherwise as to their accuracy. No person in this firm's employment has the authority to make or give any representation or warranty in respect of the property.